

# PIONEERING THE NEXT GENERATION



**CFAC SOLUTION WORKBOOK**  
SEVASTOPOL SCHOOL DISTRICT | 07.25.18



Wednesday | July 25, 2018

**EXISTING / PROPOSED SPACE PROGRAM COMPARISON**  
**PreK-5th Grade Elementary School & MS / HS Tech. Ed. / Art / Science Addition**

No.	Program Area	Existing Net Space Allocation			Proposed Net Space Allocation			Notes
		Area	No	Total Net Area	Area	No	Total Net Area	
<b>1.00</b>	<b>Early Childhood</b>							
1.01	Classrooms	730	1	730	900	1	900	
1.02	Classroom storage	-	-	-	100	1	100	
1.03	Classroom unisex toilet	-	-	-	65	1	65	
1.04	Lockers / cubbies	-	-	-	2.50	18	45	
	<b>Total 4-Year Old Kindergarten:</b>			<b>730</b>			<b>1,110</b>	
<b>2.00</b>	<b>4-Year Old Kindergarten</b>							
2.01	Classrooms	900	1	900	1,200	1	1,200	
2.02	Classrooms	1,364	1	1,364	1,200	1	1,200	
2.02	Classroom storage	82	1	82	150	1	150	Shared between (2) classrooms
2.03	Classroom unisex toilet	-	-	-	65	2	130	
2.04	Lockers / cubbies	-	-	-	2.50	36	90	In room or in hallway
	<b>Total 4-Year Old Kindergarten:</b>			<b>2,346</b>			<b>2,770</b>	
<b>3.00</b>	<b>Kindergarten</b>							
3.01	Classroom	1,306	1	1,306	1,200	1	1,200	
3.02	Classroom	1,329	1	1,329	1,200	1	1,200	
3.03	Aide	140	1	140	140	1	140	
3.04	Storage	-	-	-	150	1	150	Shared between (2) classrooms
3.05	Classroom unisex toilet	85	1	85	85	1	85	
3.06	Lockers / cubbies	-	-	-	2.50	60	150	
	<b>Total Kindergarten:</b>			<b>2,860</b>			<b>2,925</b>	
<b>4.00</b>	<b>1st Grade</b>							
4.01	Classroom	810	1	810	900	1	900	
4.02	Classroom	730	1	730	900	1	900	
4.03	Small group instruction	-	-	-	150	1	150	
4.04	Grade level storage	-	-	-	100	1	100	
4.05	Lockers / cubbies	-	-	-	2.50	60	150	
	<b>Total 1st Grade:</b>			<b>1,540</b>			<b>2,200</b>	
<b>5.00</b>	<b>2nd Grade</b>							
5.01	Classroom	645	1	645	900	1	900	
5.02	Classroom	645	1	645	900	1	900	
5.03	Small group instruction	-	-	-	150	1	150	
5.04	Grade level storage	-	-	-	100	1	100	
5.05	Lockers / cubbies	-	-	-	2.50	60	150	
	<b>Total 2nd Grade:</b>			<b>1,290</b>			<b>2,200</b>	
<b>6.00</b>	<b>3rd Grade</b>							
6.01	Classroom	785	1	785	900	1	900	
6.02	Classroom	785	1	785	900	1	900	
6.03	Small group instruction	-	-	-	150	1	150	
6.04	Grade level storage	-	-	-	100	1	100	
6.05	Lockers / cubbies	-	-	-	2.50	60	150	
	<b>Total 3rd Grade:</b>			<b>1,570</b>			<b>2,200</b>	
<b>7.00</b>	<b>4th Grade</b>							
7.01	Classroom	1,240	1	1,240	900	1	900	
7.02	Classroom	730	1	730	900	1	900	
7.03	Small group instruction	-	-	-	150	1	150	
7.04	Grade level storage	-	-	-	100	1	100	
7.05	Lockers / cubbies	-	-	-	2.50	60	150	
	<b>Total 4th Grade:</b>			<b>1,970</b>			<b>2,200</b>	
<b>8.00</b>	<b>5th Grade</b>							

No.	Program Area	Existing Net Space Allocation			Proposed Net Space Allocation			Notes
		Area	No	Total Net Area	Area	No	Total Net Area	
8.01	Classroom	730	1	730	900	1	900	
8.02	Classroom	860	1	860	900	1	900	
8.03	Small group instruction	-	-	-	150	1	150	
8.04	Grade level storage	-	-	-	100	1	100	
8.05	Lockers / cubbies	-	-	-	2.50	60	150	
<b>Total 5th Grade:</b>				<b>1,590</b>			<b>2,200</b>	
<b>9.00 6th Grade</b>								
9.01	Classroom	815	1	815	900	1	900	
9.02	Classroom	785	1	785	900	1	900	
9.03	Small group instruction	-	-	-	150	1	150	
9.04	Grade level storage	-	-	-	100	1	100	
9.05	Lockers / cubbies	-	-	-	2.50	60	150	
<b>Total 6th Grade:</b>				<b>1,600</b>			<b>2,200</b>	
<b>10.00 Computers / Technology</b>								
10.01	Computer labs	660	1	660	900	1	900	
<b>Total Computers / Technology:</b>				<b>660</b>			<b>900</b>	
<b>11.00 Special Education</b>								
11.01	Speech and language	450	1	450	450	1	450	
11.02	Speech and language	200	1	200	200	1	200	
11.03	Spec. Ed.	800	1	800	800	1	800	
11.04	Toilet	100	1	100	100	1	100	
11.05	SE Resource (Third Floor)	230	1	230	350	1	350	
11.06	SE Resource (Third Floor)	280	1	280	350	1	350	
11.07	SE Resource (Second Floor)	185	2	370	350	2	700	
11.08	Reading Support / Title 1	1,000	1	1,000	1,000	1	1,000	
11.09	Bookroom	400	1	400	400	1	400	
11.10	Aide	290	1	290	290	1	290	
11.11	4K - 2nd Spec. Ed.	600	-	-	600	-	-	
11.12	3rd - 5th Spec. Ed.	600	-	-	600	1	600	
11.13	OT/PT	400	-	-	400	1	400	Adjacent to 4K - 2nd Spec. Ed.
11.14	Storage - large motor equipment	150	-	-	150	1	150	
11.15	Sensory	165	1	165	165	1	165	
11.16	Storage	150	1	150	150	1	150	
11.17	ELL	200	1	200	200	1	200	
11.18	Title 1	900	-	-	900	-	-	
11.19	Bookroom	400	-	-	400	-	-	
11.20	Conference room	300	-	-	300	-	-	
11.21	Toilet room / changing area / shower	120	-	-	120	1	120	
11.22	Laundry	250	-	-	250	-	-	
11.23	Kitchen / kitchenette	250	-	-	250	-	-	
11.24	Special Ed. Director	250	-	-	250	1	250	
11.24	Special Ed. Assistant	180	-	-	180	-	-	
11.25	Record Storage	100	-	-	100	-	-	
<b>Total Special Education:</b>				<b>4,635</b>			<b>6,675</b>	
<b>12.00 Elementary Art</b>								
12.01	Classrooms	1,160	1	1,160	1,400	1	1,400	
12.02	Storage	150	-	-	150	1	150	
12.03	Kiln	100	-	-	100	1	100	1 kiln & shelving
12.04	Student work storage	150	-	-	150	1	150	
<b>Total Art:</b>				<b>1,160</b>			<b>1,800</b>	
<b>13.00 Elementary Library</b>								
13.01	Library	1,620	1	1,620	1,800	1	1,800	Story nook
13.02	Office / work room	200	-	-	200	1	200	
13.03	Storage	220	1	220	220	1	220	
13.04	Small group instruction / conference	200	-	-	200	1	200	
<b>Total Library:</b>				<b>1,840</b>			<b>2,420</b>	
<b>14.00 Elementary Administration &amp; Student Services</b>								
14.01	District Office	530	1	530	530	1	530	
14.02	Storage / Work	120	1	120	120	1	120	
14.03	Superintendent	330	1	330	330	1	330	
14.04	Principal office	125	1	125	210	1	210	

No.	Program Area	Existing Net Space Allocation			Proposed Net Space Allocation			Notes
		Area	No	Total Net Area	Area	No	Total Net Area	
14.05	Storage / Closet	120	1	120	-	-	-	
14.06	Health room / health assistant	300	-	-	300	1	300	
14.07	Toilet room	80	-	-	80	1	80	
14.08	Shared psych. / social / guidance	175	-	-	175	1	175	
14.09	Reception / lobby / waiting area	300	-	-	250	1	250	
14.10	Paraprofessional work stations	200	1	200	200	1	200	
14.11	Copy / work room	350	-	-	250	1	250	
14.12	Records storage room	120	1	120	120	1	120	
14.13	Toilet rooms	65	-	-	65	1	65	
14.14	Conference / work room	450	1	450	350	1	350	
14.15	Conference room	450	1	450	-	-	-	
<b>Total Admin. &amp; Student Services:</b>				<b>1,465</b>			<b>2,000</b>	
<b>15.00 Technology Education</b>								
15.01	Woods Lab	1,050	1	1,050	2,000	1	2,000	Overhead door
15.02	Storage/Finishing	770	1	770	400	1	400	
15.03	Metals Lab	1,260	1	1,260	1,800	1	1,800	Chain hoist & large overhead door
15.04	Storage/Tools	-	-	-	350	1	350	
15.05	Welding Booths	-	-	-	600	1	600	Space for sheet metal equipment & (8) booths
15.06	Auto Bay	-	-	-	300	1	300	
15.07	STEM Classroom/FAB Lab	1,325	1	1,325	1,400	1	1,400	Connect to Business Ed.
15.08	Computer Lab	740	1	740	1,400	1	1,400	Connect to all Tech. Ed. spaces
15.09	Graphics Lab	270	1	270	1,400	1	1,400	
15.10	Department Office	80	1	80	200	1	200	50 sq. ft. per staff member
<b>Total Technology Education Area:</b>				<b>5,495</b>			<b>9,850</b>	
<b>16.00 Agriculture</b>								
16.01	Ag Classroom/Agriscience Lab	680	1	680	1,200	1	1,200	
16.02	Greenhouse	1,300	1	1,300	1,400	1	1,400	
16.03	Storage / Work Room	-	-	-	100	1	100	
<b>Total Agriculture Area:</b>				<b>1,980</b>			<b>2,700</b>	
<b>17.00 MS / HS Art</b>								
17.01	Classroom	1,250	1	1,250	1,400	1	1,400	
17.02	Kiln	100	-	-	100	1	100	
17.03	Storage	290	1	290	250	1	250	
17.04	Student Project Storage	250	-	-	250	1	250	
<b>Total Art Area:</b>				<b>1,540</b>			<b>2,000</b>	
<b>18.00 Staff Work &amp; Break</b>								
18.01	Work room / Lunch	290	1	290	600	1	600	Copy machines, laminators, work area, etc.
18.02	Mailboxes	25	-	-	25	-	-	
18.03	Toilet rooms	65	-	-	65	-	-	
<b>Total Staff Work &amp; Break:</b>				<b>290</b>			<b>600</b>	
<b>19.00 Maintenance / Janitorial</b>								
19.01	Janitor's Closet	100	2	200	100	2	200	
19.02	General Building Storage	350	1	350	350	1	350	
19.03	Receiving/Maintenance	2,475	1	2,475	2,475	1	2,475	
19.04	B&G Office	385	1	385	385	1	385	
19.05	Data Rooms	-	-	-	25	-	-	
19.06	Elevator	-	-	-	150	1	150	
19.07	Elevator Equipment	-	-	-	75	1	75	
<b>Total Maintenance / Janitorial:</b>				<b>3,410</b>			<b>3,635</b>	
<b>20.00 Shared/Common Space</b>								
20.01	Multipurpose Space	3,000	1	3,000	3,000	1	3,000	
20.02	Toilet Rooms	200	6	1,200	250	8	2,000	
20.03	Concessions	-	-	-	250	-	-	
20.04	Family Restroom	-	-	-	100	-	-	
20.05	Gallery/Display Space	-	-	-	250	-	-	
<b>Total Shared/Common Area:</b>				<b>4,200</b>			<b>5,000</b>	
<b>Total Building Area - Net:</b>				<b>42,171</b>			<b>57,585</b>	

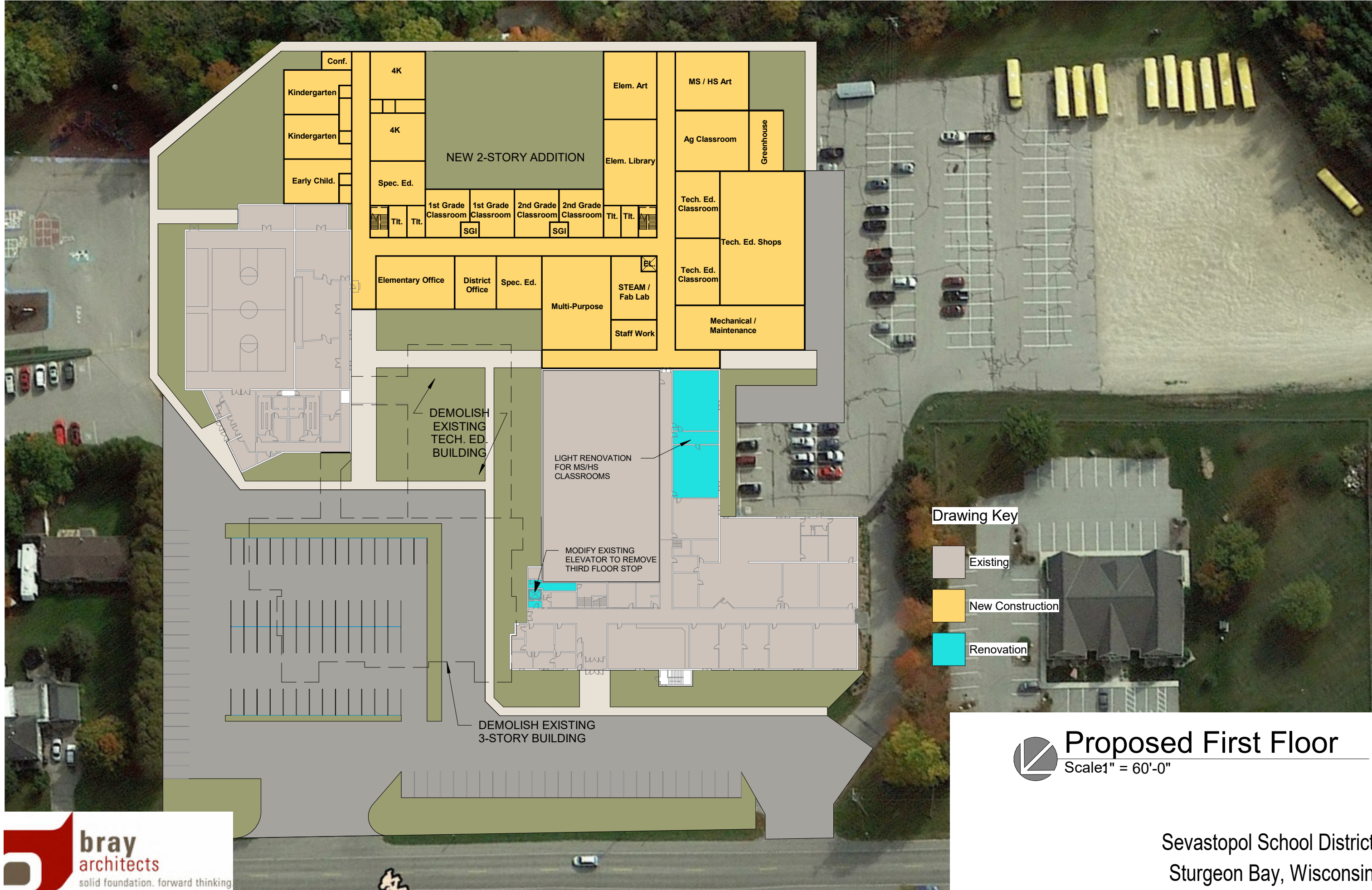

**Drawing Key**

- Existing
- New Construction
- Renovation



**Proposed First Floor**

Scale 1" = 60'-0"

Sevastopol School District  
Sturgeon Bay, Wisconsin

July 25, 2018



Project #:3212

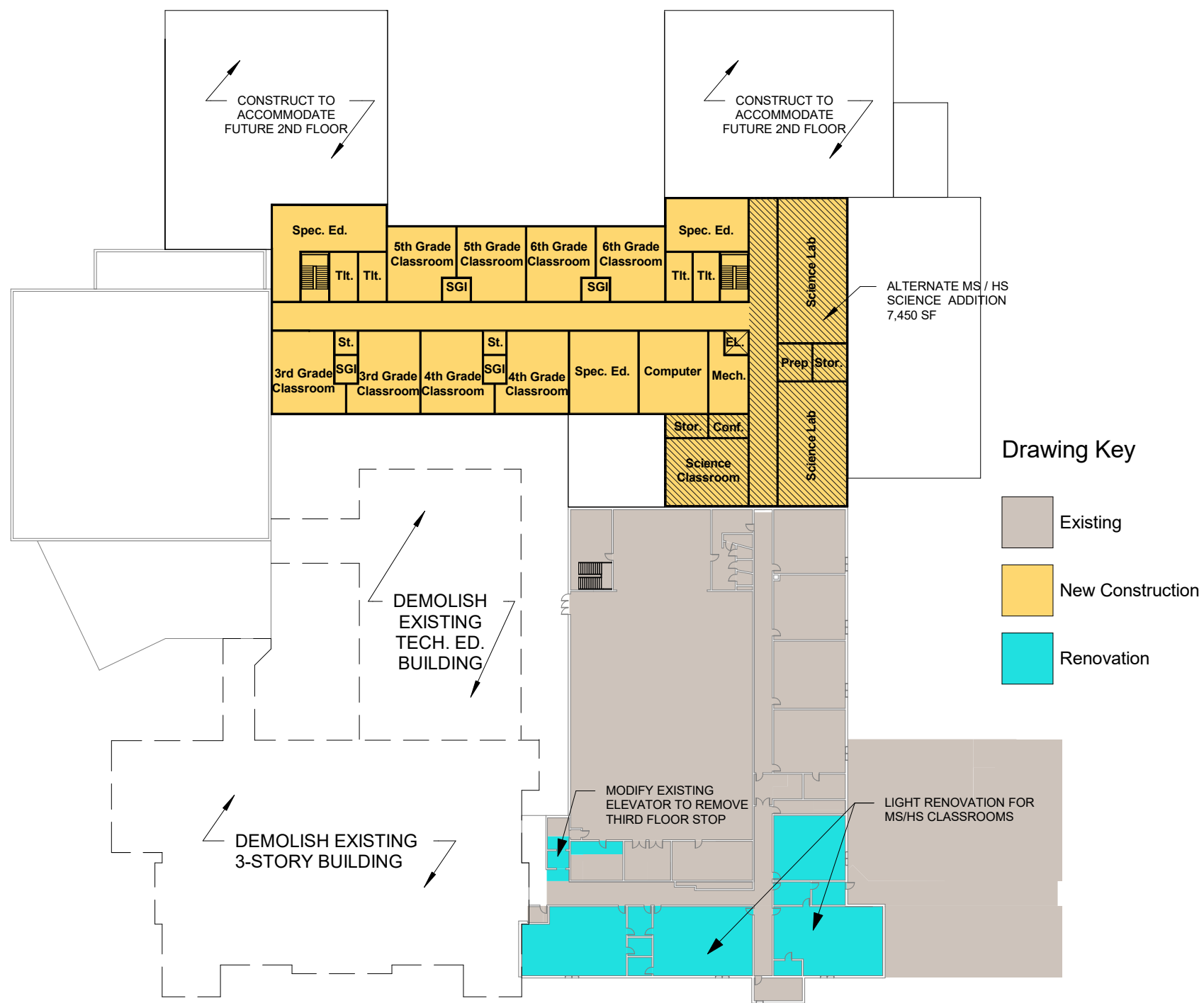

**Proposed Second Floor**  
 Scale 1" = 60'-0"



Sevastopol School District



Addition / Renovation			
7/25/2018			
Description		November 2018 Referendum	April 2019 Referendum
<b>Base Project Cost</b>		<b>\$ 25,152,793</b>	<b>\$ 26,158,905</b>
<b>Renovations to Existing School</b>		<b>\$ 965,039</b>	<b>\$ 1,003,641</b>
Building Interior Improvements		\$ 579,705	
Building Systems		\$ 236,270	
Owner Items		\$ 149,065	
<b>New Construction</b>		<b>\$ 24,187,754</b>	<b>\$ 25,155,264</b>
Renovations/Demo Associated with New Construction			
Renovations/Demo Associated with New Construction Subtotal		\$ 1,384,680	
New Construction - K - 12th Grade Levels			
New Construction Subtotal		\$ 17,776,871	
Site Development			
Site Development Subtotal		\$ 3,730,702	
Owner Items			
Owner Items Subtotal		\$ 1,295,500	
<b>Alternate #1 Add 2nd Floor Science to Addition</b>		<b>\$ 1,988,232</b>	<b>\$ 2,067,761</b>
New Construction - Science Addition			
New Construction Subtotal		\$ 1,909,982	
Owner Items			
Owner Items Subtotal		\$ 78,250	
<b>Alternate #2 - Paving South Parking Lot (153 Stalls)</b>		<b>\$ 350,617</b>	<b>\$ 364,641</b>
Site Development			
Site Development Subtotal		\$ 350,617	
<b>Total with Alternates #1 and #2</b>		<b>\$ 27,491,642</b>	<b>\$ 28,591,307</b>

**Not Included:**

- Ripp Road paving
- Existing Bus Garage Drive to the south / Lighting, Etc.
- Poor Soil Requirements
- Any work to existing Athletic Fields
- Any work related to Sink Holes
- New Playground
- Specialty Athletic Equipment (wrestling mats, batting cages, etc.)

# School District of Sevastopol

## SUMMARY OF HYPOTHETICAL REFERENDUM SCENARIOS

PRELIMINARY

<b>REFERENDUM AMOUNT</b>	<b>\$25,000,000</b>	<b>\$27,500,000</b>
--------------------------	---------------------	---------------------

**MAX MILL RATE IMPACT** (over 2017-18)  
(Per \$1,000 valuation)

\$1.19

\$1.19

**TAX IMPACT ON PROPERTY WITH FAIR MARKET VALUE OF:**

**\$100,000 Home**  
*Maximum Impact*  
*Monthly Impact*

\$119.00  
\$9.92

**\$200,000 Home**  
*Maximum Impact*  
*Monthly Impact*

\$238.00  
\$19.83

**\$300,000 Home**  
*Maximum Impact*  
*Monthly Impact*

\$357.00  
\$29.75

\$132.00  
\$11.00

\$264.00  
\$22.00

\$396.00  
\$33.00



**Assumptions:**

Phased Borrowing Approach to keep all referendum debt Bank Qualified. Assumes interest rates of 4.25% - 4.75%. Mill rate based on 2017 Equalized Valuation (TID-OUT) of \$1,388,253,213 with annual growth of 0.00%.

*Robert W. Baird & Co. Incorporated ("Baird") is not recommending any action to you. Baird is not acting as an advisor to you and does not owe you a fiduciary duty pursuant to Section 15B of the Securities Exchange Act of 1934. Baird is acting for its own interests. You should discuss the information contained herein with any and all internal or external advisors and experts you deem appropriate before acting on the information. Baird seeks to serve as an underwriter (or placement agent) on a future transaction and not as a financial advisor or municipal advisor. The primary role of an underwriter (or placement agent) is to purchase, or arrange for the placement of, securities in an arm's length commercial transaction with the issuer, and it has financial and other interests that differ from those of the issuer. The information provided is for discussion purposes only, in seeking to serve as underwriter (or placement agent). See "Important Disclosures" contained herein.*

# SCHOOL DISTRICT OF SEVASTOPOL

## Milestone Map | Addition & Renovations

### November 2018 Referendum

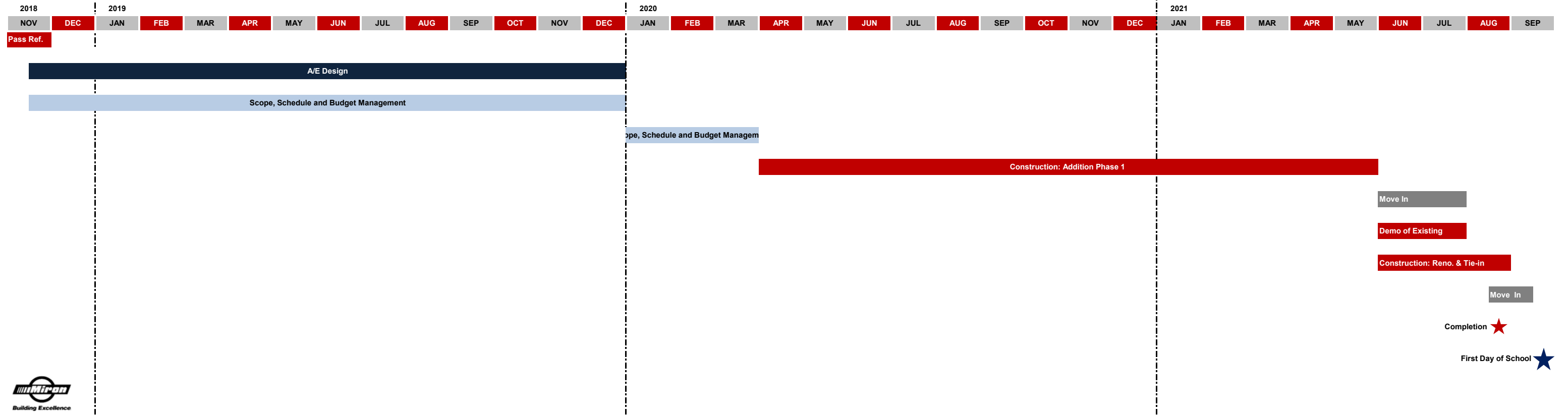

# SCHOOL DISTRICT OF SEVASTOPOL

## Milestone Map | Addition & Renovations

### April 2019 Referendum

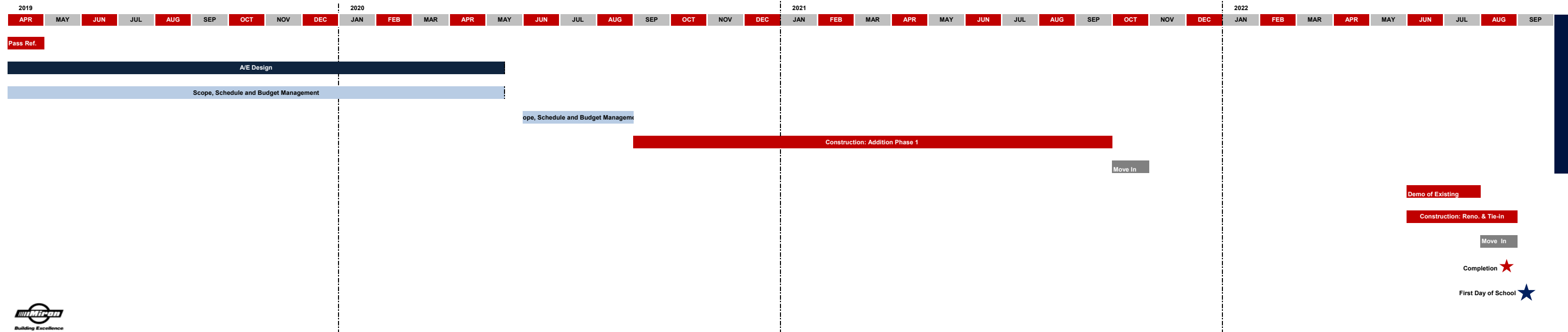



# PIONEERING THE NEXT GENERATION

